

3/6/99

COPE Associates Incorporated
Architecture
2807 Kingston Pike • Suite 6
Knoxville, Tennessee
(423) 884-0000 • (423) 584-8885
FAX Number (423) 584-1886

ROUGH GRADING PLAN

REVISIONS	
No.	Date
1	10/20/98
2	10/30/98
3	11/11/98
4	3/6/99

Plot Scale	1"=40'
Dwn.	CDB
Appd.	EJB
Project No.	97-126
Date	9/25/98
Sh. No.	
of	

C11

LAND DEVELOPMENT SOLUTIONS
310 SIMMONS RD., SUITE K • KNOXVILLE, TENNESSEE 37922 • PH: 423-671-2281

LDS Copy
3/8/99

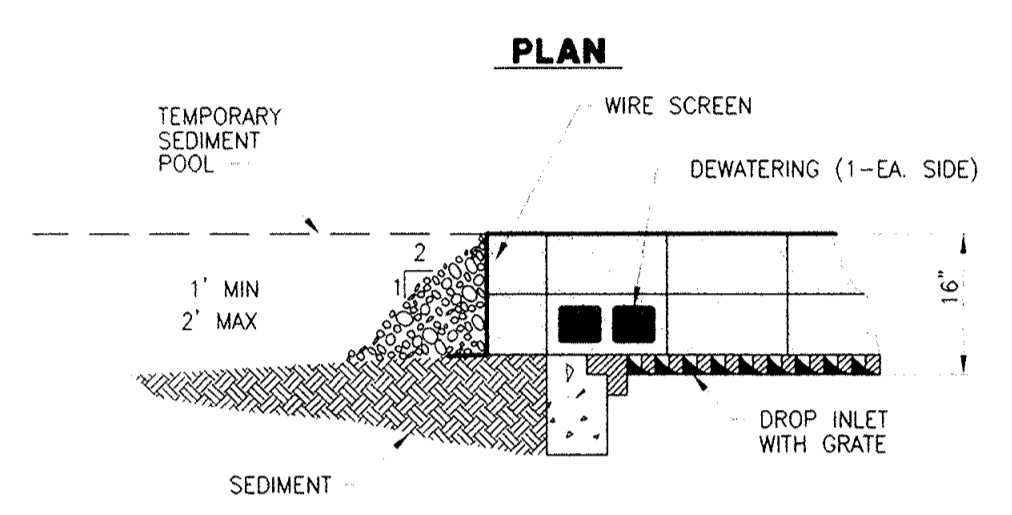
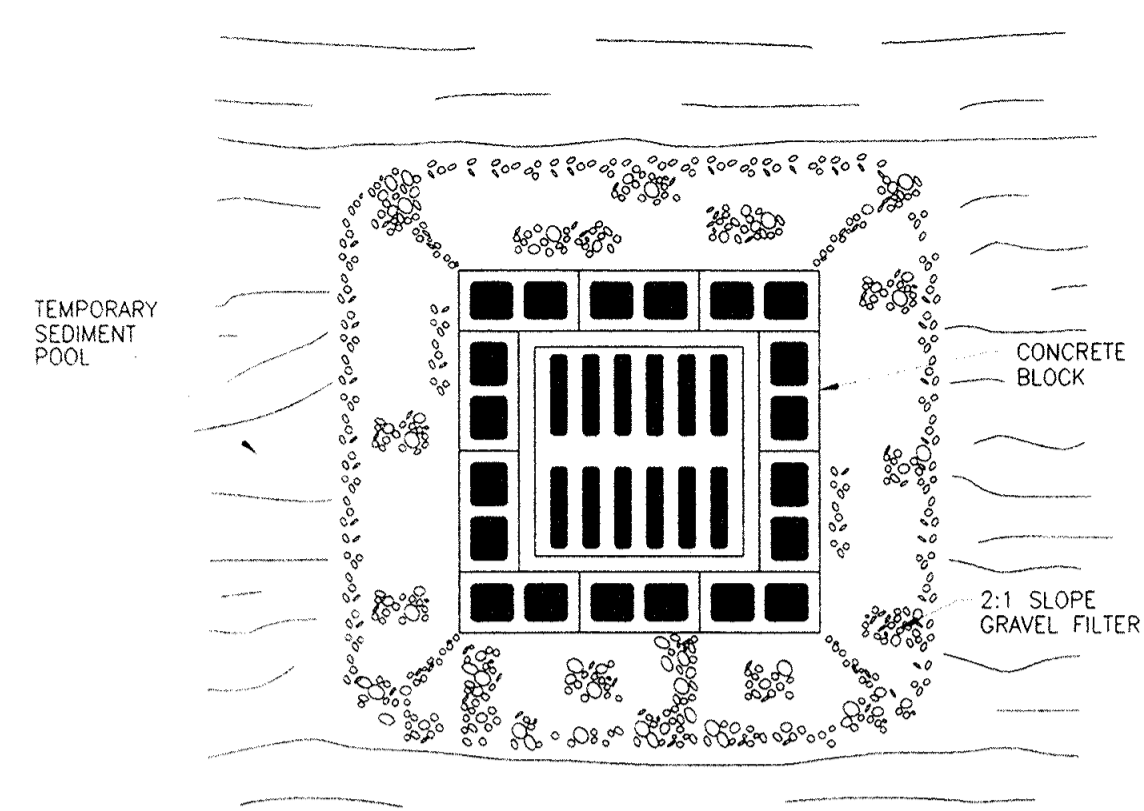
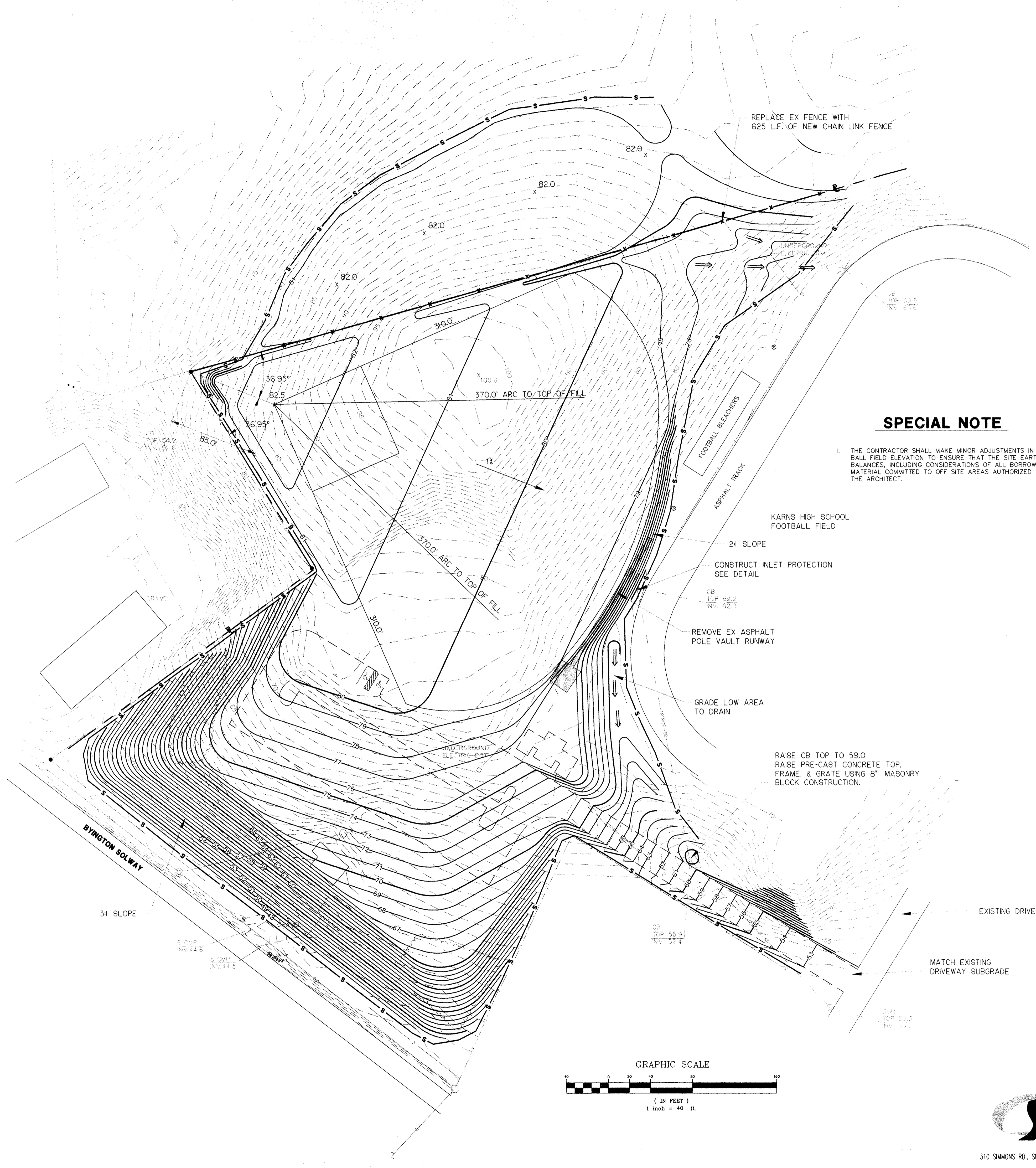

ELEVATION
INLET PROTECTION
N.T.S.

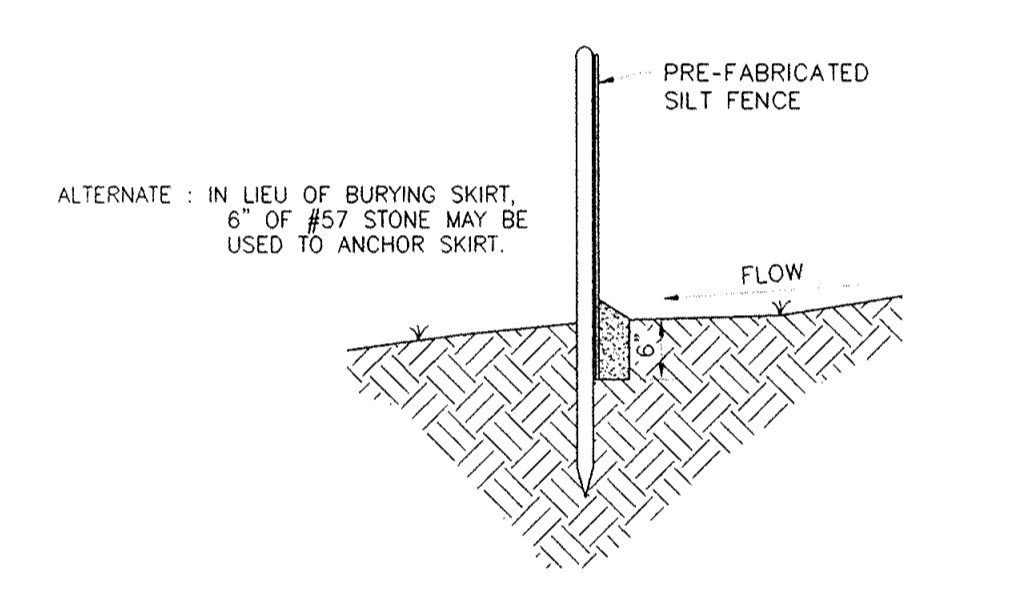

TEMPORARY SILT FENCE
N.T.S.

LEGEND

- EX 5' CONTOUR
- EX 1' CONTOUR
- NEW 5' CONTOUR
- NEW 1' CONTOUR
- EX STORM LINE
- EX FENCE
- EX EDGE OF PAVEMENT
- NEW SILT FENCE

NOTES

- THE CONTRACTOR IS SPECIFICALLY CAUTIONED THAT THE LOCATION AND/OR ELEVATION OF EXISTING UTILITIES AS SHOWN ON THESE PLANS IS BASED ON RECORDS AND WHERE POSSIBLE MEASUREMENTS TAKEN IN THE FIELD. THIS INFORMATION IS NOT TO BE RELIED UPON AS BEING EXACT OR COMPLETE. THE CONTRACTOR MUST CALL TENNESSEE ONE CALL AND ANY UTILITY THAT DOES NOT SUBSCRIBE TO ONE CALL AT LEAST 72 HOURS BEFORE ANY EXCAVATION, TO REQUEST EXACT FIELD LOCATION OF THE UTILITIES. IT SHALL BE THE RESPONSIBILITY OF THE CONTRACTOR TO RELOCATE ALL EXISTING UTILITIES WHICH CONFLICT WITH THE PROPOSED IMPROVEMENTS SHOWN ON THE PLANS.
- CONTRACTOR SHALL REMOVE TOPSOIL IN AREAS TO BE GRADED AND TEMPORARILY STOCKPILE ON SITE WHERE APPROVED BY ARCHITECT.
- CONTRACTOR SHALL NOT WASTE EXCESS GRADED MATERIAL ON SITE OR ADJOINING PROPERTIES WITHOUT WRITTEN APPROVAL OF THE PROPERTY OWNER AFFECTED AND APPROVAL BY THE ARCHITECT.
- TOPSOIL SHALL BE PLACED ON ALL DISTURBED EARTH AREAS. TOPSOIL THICKNESS ON THE ADJOINING PROPERTY TO THE NORTH SHALL BE 6 TO 10 INCHES. TOPSOIL SHALL BE PLACED IN 2 TO 4 INCH THICKNESS OVER THE REMAINING SITE.
- CONTRACTOR SHALL REPLACE THE EXISTING FENCE BETWEEN THE SCHOOL PROPERTY AND THE PROPERTY TO THE NORTH WITH A SIX FEET HIGH CHAIN LINK FENCE.

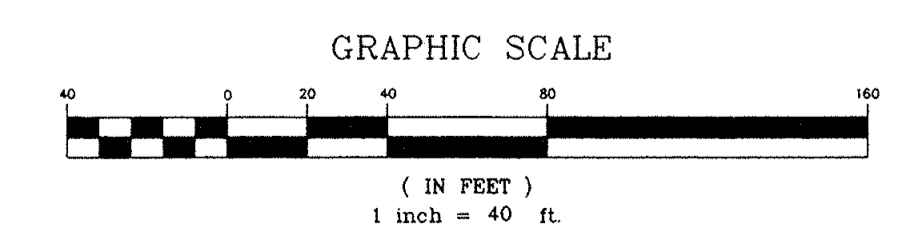

SPECIAL NOTE
1. THE CONTRACTOR SHALL MAKE MINOR ADJUSTMENTS IN THE BALL FIELD ELEVATION TO ENSURE THAT THE SITE EARTHWORK BALANCES, INCLUDING CONSIDERATIONS OF ALL BORROW MATERIAL COMMITTED TO OFF SITE AREAS AUTHORIZED BY THE ARCHITECT.

